

225 VARICK STREET

Partial 6th Floor ■ 18,540 SF

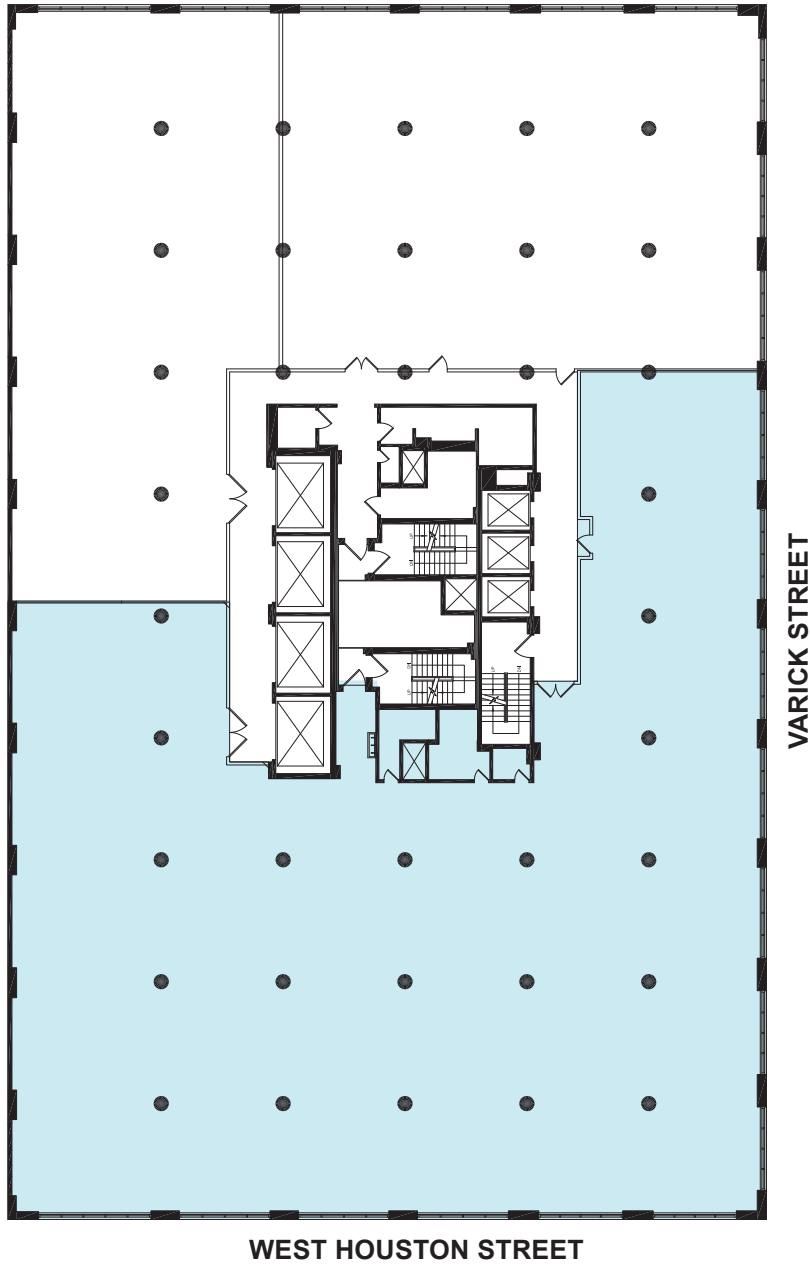

For further information contact:

PATRICE MEAGHER
212.984.7112

STUART SIEGEL
212.984.8149

ZAK SNIDER
212.984.6625

BENJAMIN JOSEPH
212.984.8206

Exclusive Leasing Agent

CBRE